



# Fab-Lok® Fasteners

To maintain panel integrity in high-stress and high-vibration environments



Made in  
the U.S.A.



Vibration, either from inside or outside a building, can make ordinary fasteners loosen and back out. Fab-Lok fasteners combine a slotted aluminum sleeve and fastener to provide high resistance to vibration loosening. Excellent for use with insulated panels.

## Specifications

- Drive System: Hex
- Materials: Low carbon steel or 300 series stainless steel screw with aluminum sleeve
- Finish: Zinc

## Features & Benefits

- Hex washer head machine screw assembled to a slotted aluminum sleeve and EPDM sealing washer
- After tightening, clamping times remain in place even if screw is removed
- Greater joint integrity with clamping force

Catalog No.	Description	Penetrating Length	Grip Range	Carton Quantity	Carton Weight
<b>Carbon Steel</b>					
EZJ100	FAS-10-4	1.373"	.062" - .250"	1,000	22
EZJ120	FAS-10-8	1.612"	.250" - .500"	1,000	23
EZJ140	FAS-10-12	1.807"	.500" - .750"	1,000	27
<b>H3 (300 Series) Stainless Steel</b>					
EZJ210	FAC-10-4	1.373"	.062" - .250"	1,000	21
EZJ230	FAC-10-8	1.612"	.250" - .500"	1,000	25
EZJ250	FAC-10-12	1.807"	.500" - .750"	1,000	27
<b>Fab-Lok Drive Tools*</b>					
EZJ900	Holding Sleeve with Socket			1	

\*Fab-Lok fastener is inserted into a 5/16" hole (hole size is not critical) then installed with a power driver equipped with a Fab-Lok holding sleeve, with a socket designed to fit DeWalt® tools DW969K-2, DW968K-2, DW267, DW268 and DW269.

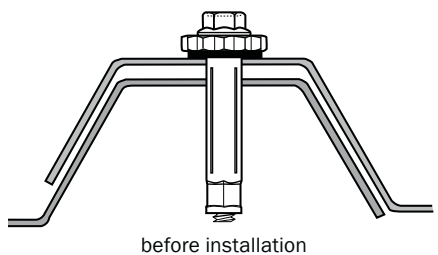

before installation

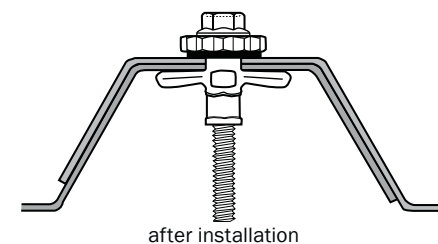

after installation

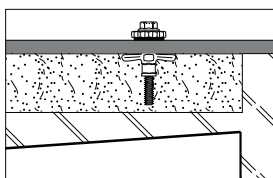

can be easily used in blind applications

## Ultimate Shear (lbs)

Screw Material	
Carbon	Stainless
2400	1885

## Pull-Out (lbs)

### Single Sheet

Material Thickness	Pull-Out	Failure Mode
26 ga.	612	Sheet Split
24 ga.	833	Sheet Split
20 ga.	858	Sheet Split
18 ga.	1050	Sheet Split
16 ga.	1293	Sheet Split
14 ga.	1400	Broken Fastener

### Double Steel Sheet

Material Thickness	Pull-Out	Failure Mode
26 ga.	1160	Sheet Split
20 ga.	1345	Broken Fastener

### Double Aluminum Sheet

Material Thickness	Pull-Out	Failure Mode
0.032"	915	Sheet Split

## Head Marking Designations

- Carbon steel screw: 4 dots in horizontal line
- Stainless steel screw: "F" above "2"

